

**SIGN CRITERIA FOR
PUSCH RIDGE CENTRE
10351, 10361 & 10371 NORTH ORACLE ROAD
ORO VALLEY ARIZONA 85737**



Pusch Ridge Centre

TABLE OF CONTENTS

PAGE	
1	SITE MAP
2	FREESTANDING SIGNAGE
3-5	BUILDING ELEVATION SIGN LOCATIONS AND SUITE DOOR EXAMPLES.
6-7	SIGN CRITERIA Introduction A. General Requirements B. General Specifications C. Design Requirements - Building Signs D. Monument Sign E. Miscellaneous Requirements F. Existing Signs
8	COLOR PALETTE

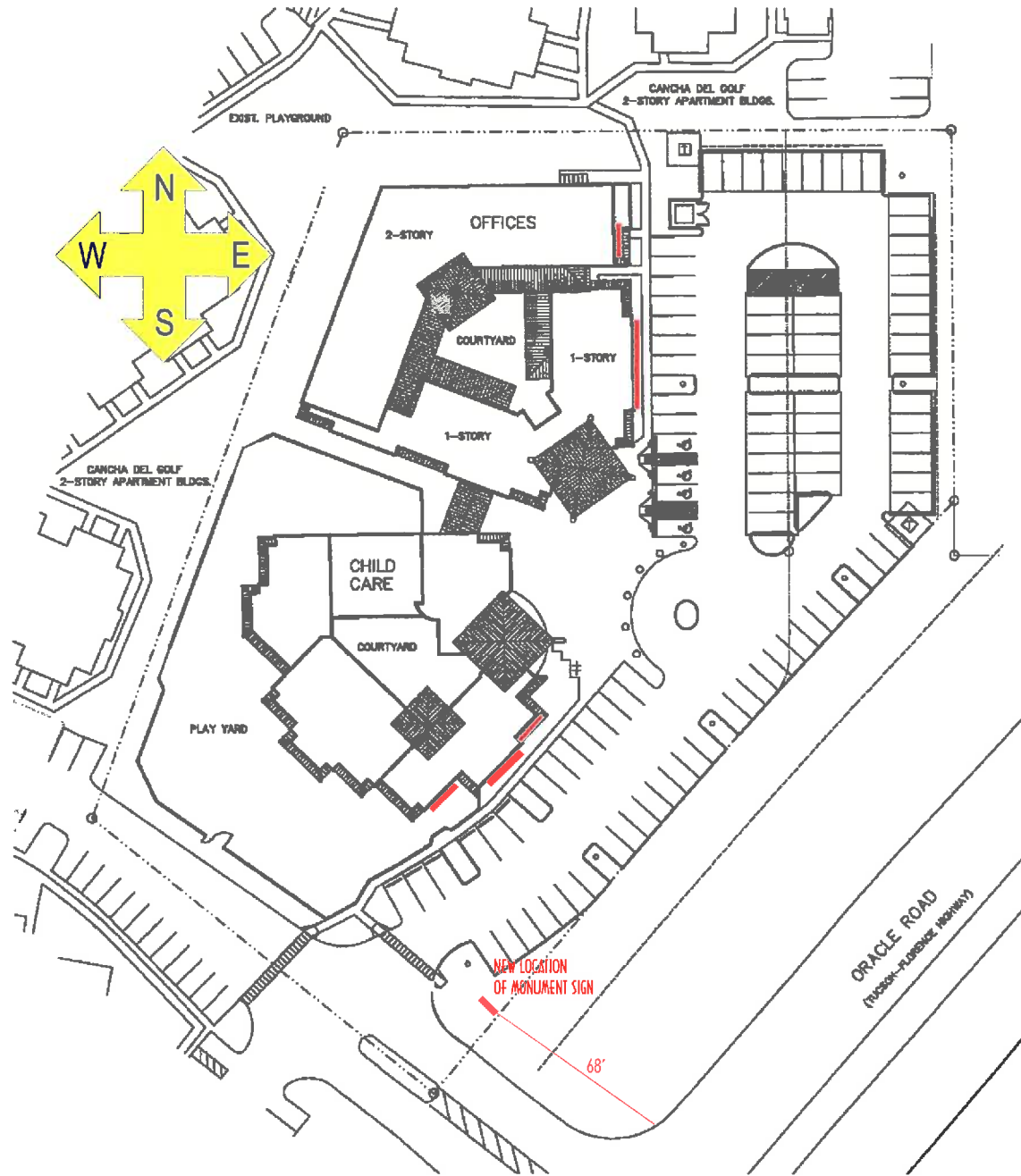

 = WALL SIGN LOCATIONS

A. FREESTANDING SIGNAGE

Pusch Ridge Centre is allowed one monument sign at the entrance off of Oracle Road. The current sign is in compliance with prior TOV sign codes. Its construction is concrete blocks with a painted stucco finish. The name of the complex is the only copy on the sign. Letters are copper Reverse Pan Channel with neon illumination.



NTS EXISTING MONUMENT

Replacement to be constructed of aluminum with two sided sign with four individual panels with tenants names and one for development name. All tenant names to be push thru white acrylic with white LED illumination. Centre name shall be smaller but of the same construction with polished copper faces laminated to front of clear acrylic.

Sign shall be painted Matthews Copper and Dopplebock (dark brown)



NTS

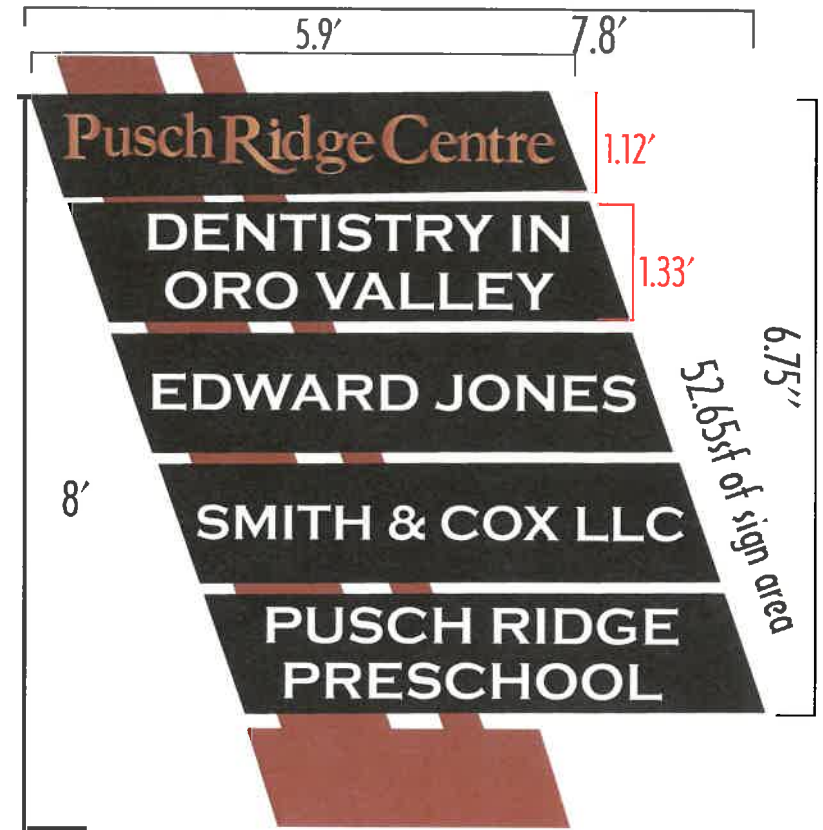

CURRENT EXTERIOR SIGNS

10351



10371



10371



10371



COVER PARKING SIGNS



EXTERIOR SIGNS LOCATIONS

10361 N. Oracle Road



EAST ELEVATION - NTS

10371 N. Oracle Road



EAST ELEVATION - NTS

10371 N. Oracle Road



EAST ELEVATION - NTS



DOOR LETTERING



1.5" SUITE NUMBER CENTERED WITH TOP
1" FROM TOP OF GLASS.
CLEARFACE-HEAVY DTC FONT

TENANT'S INFORMATION CENTERED WITH TOP
20.5" FROM TOP OF DOOR.
FONT IS OPEN WITH LANDLORD APPROVAL
AND NOT EXCEED 3 SF.



EXISTING DOOR TYPES

PUSCH RIDGE CENTRE

SIGN CRITERIA

INTRODUCTION:

The sign criteria conforms to Oro Valley Sign Code and allow our tenants to display the most Attractive and cost effective signs that will attract and direct clients to their offices. This criteria also will make sure all signs conform to a uniform quality and display standard. All provisions of the Oro Valley Zoning Code will apply.

A. GENERAL LANDLORD REQUIREMENTS FOR TENANTS

1. The tenants sign contractor shall provide the Landlord with two (2) sets of shop drawings showing specifications on size, materials, colors and construction.
2. The Landlord shall review the shop drawings and either approve or request tenant to "revise and re-submit as noted". If the drawing needs revisions, the sign contractor shall make appropriate changes and re-submit to the Landlord.
3. After final Landlord approval is furnished, the sign contractor shall submit drawings and application for the sign permits.
4. No other type of signs shall be displayed without Landlords approval and permits approved by Oro Valley Development Services.
5. Tenant is responsible for all costs associated with the design, manufacture and installation of all signs. Tenant is responsible for the removal of all signs at the end of the lease. All damage to the building is the sole responsibility of the tenant to repair.
6. Landlord to approve if space for exterior sign is available and final location.
7. Permits must be submitted to TOV Development services and approved prior to installation.

B. GENERAL SPECIFICATIONS

1. All power supplies, transformers, conductors shall be concealed. All labels shall be put in an inconspicuous place on the letters.
2. No Flashing or animation signs are allowed.

C. DESIGN REQUIREMENTS – BUILDING SIGNS

1. Building signs are to be Reverse Pan Channel Letters (RPC) or flat cut out letters (FCO) as approved by the Landlord.
2. Building signs shall be placed on one exterior wall as per approved by Landlord.
3. Building signs are allowed 1sf of sign for each linear foot of leased frontage. Spaces with less than 15 feet of frontage are allowed up to 15sf and the maximum allowed for any sign is 30sf.

4. Any letter font style can be used with Landlords approval. Letter height is open upon Landlords approval. Building signs shall not contain more than two lines of copy.
5. Building signs shall be constructed with polished copper and other UL approved elements and carry Underwriters Laboratory Marks or from some certified testing program. New illuminated building signs shall use white LED lighting with a Kelvin Temperature to meet TOV standards and needs to be "halo" illumination.
6. Building signs shall consist of the tenant's business name. no services will be allowed.
7. Logos must be State and Federally registered trademarks and not take up more than 40% of the sign area.

D. MONUMENT SIGN

1. A new monument sign will be constructed and moved closer to Oracle Road as allowed.
2. Monument will consist of one panel with the name of the center and four panels that will have tenants name as approved by the Landlord.
3. The Landlords panel shall have white push thru acrylic letters with polished copper face laminated to the front. Tenant panels shall be white push thru acrylic letters only.
4. Monument sign shall have white LED illumination with a Kelvin Temperature to meet Oro Valley standards.
5. Monument sign will be fabricated using UL approved materials and carry Underwriters Laboratory Marks or from some certified testing program.

E. MISCELLANEOUS REQUIREMENTS

1. Tenants shall be allowed to have up to 2sf of white vinyl lettering on their front door or window closest to door as approved by landlord. Lettering shall consist of tenants name, and if tenant requires, hours and phone number.
2. Non-customer doors may have 2" white vinyl letters with the tenant's name and suite number.
3. Covered parking name plaques to be copper with black vinyl lettering.
4. A Frame and banners are allowed by Oro Valley sign code but must be approved by the Landlord and tenant must obtain permits from Oro Valley.

F. EXISTING SIGNS

1. All existing signs are allowed to remain as legal non-conforming sign or as conforming as per this Sign Criteria.
2. All change or modifications to an existing sign shall require conformance to this sign criteria.

COLOR PALETTE

POLISHED COPPER



MATTHEWS
PAINT COLORS



MP03364
DOPPLEBOCK



MP52234
WARM COPPER

ACRYLIC COLORS

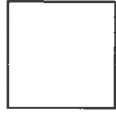

WHITE

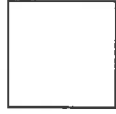

CLEAR

OPAQUE VINYL COLORS



3M
7725-12
BLACK



3M
7725-10
WHITE

ANY COLOR THAT IS PART OF A STATE AND FEDERALLY
REGISTERED TRADE MARK/LOGO IS ALLOWED